

REV.	DESCRIPTION/ECO NO.	DATE
	RELEASE & CANCEL P-0407-11	4/5/05

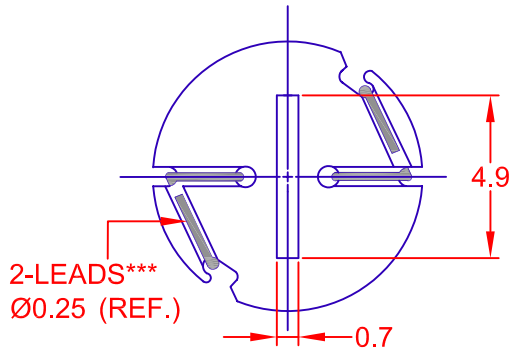
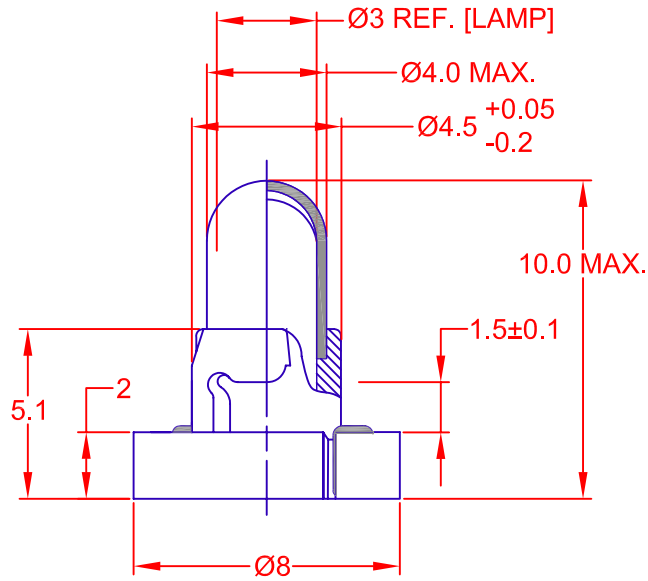
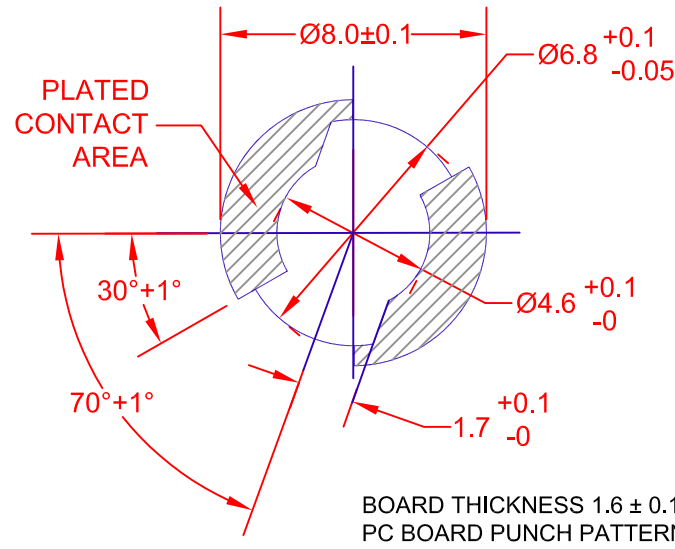

JKL PART NUMBER: CNW5-CW11/BLA/39-01-3Y/S

LAMP NUMBER: CW11**					
VOLTS RATED	AMPS ± 10%	*MSCP ± 25%	*LUMENS ± 25%	AVERAGE LIFE HRS.	FILAMENT TYPE
14.0	.065	.200	2.51	5,000 D.C.	C-2F

*LAMP RATING ONLY WITHOUT BASE AND FILTER.

**LAMP GLASS LEAD (Pb) FREE.

***PLATING LEAD (Pb) FREE.

CONTACT JKL FOR LEAD (Pb) FREE LOT IDENTIFICATION.

FILTER NUMBER: 39-01-3Y/S
COLOR COORDINATES (SPHERE)
x = .5850±.025
y = .4100±.025

BASE COLOR: BLACK

<p>THIRD ANGLE PROJECTION</p>	DIMENSIONS ARE IN MILLIMETERS TOLERANCE UNLESS OTHERWISE SPECIFIED 1 PL +/- 0.3 2 PL +/- 0.30 ANGLE +/- 0		<h1>JKL COMPONENTS CORPORATION</h1>			
			TITLE T-1 NEO-WEDGE BASED LAMP WITH FILTER			
DRAWN BY L. WENGSTROM	APPV'D BY J.K.	DATE 4/5/05	SIZE A	FSCM NO. 55335	DRAWING NO. CNW5-CW11/BLA/39-01-3Y/S	
- CAD DRAWING - MANUAL REVISIONS NOT PERMITTED			SCALE NONE	RELEASED DATE 4/5/05	REVISION DATE 	
				REV. NO. 	SHEET 1 OF 1	