

REV.	DESCRIPTION/ECO NO.	DATE
	ENGINEERING RELEASE TO CAD	3/7/05
A	ADD TOP VIEW	3/31/05

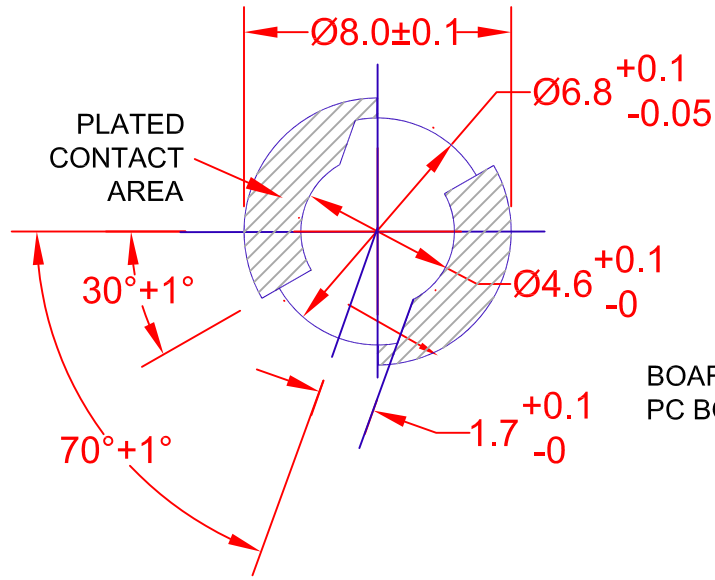

BOARD THICKNESS 1.6 ± 0.1mm.
PC BOARD PUNCH PATTERN

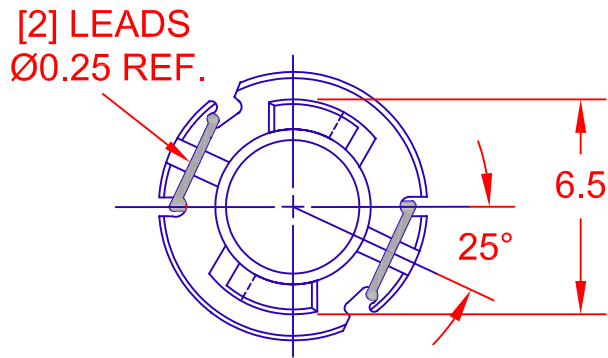
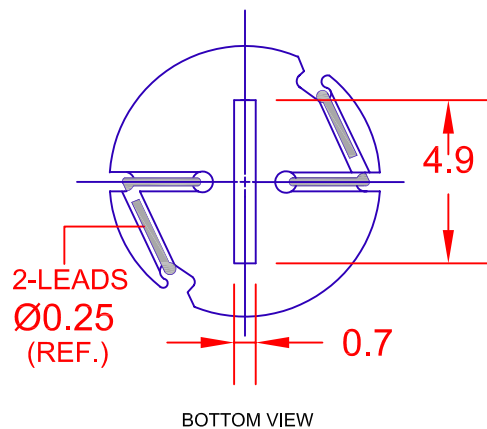
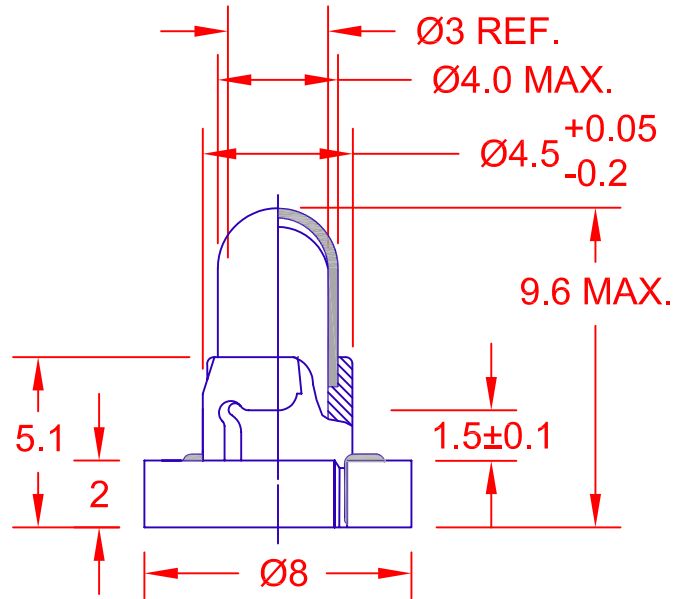

BOTTOM VIEW

JKL PART NUMBER: CNW5-8111/WHI/39-01-4C/S***

LAMP PART NUMBER: 8111**

VOLTS RATED	AMPS ± 10%	*MSCP ± 25%	*LUMENS ± 25%	AVERAGE LIFE HRS.	FILAMENT TYPE
14.0	.065	.150	1.89	10,000 D.C.	C-2F

* LAMP RATING ONLY WITHOUT BASE AND FILTER.

** LAMP GLASS LEAD (Pb) FREE.

*** LAMP AND BASE ASSEMBLY LEAD (Pb) FREE.

CONTACT JKL FOR LEAD (Pb) FREE LOT IDENTIFICATION.

FILTER PART NUMBER: 39-01-4C/S

FILTER COLOR: GREEN
COLOR COORDINATES: x = .2250 ± .025
y = .6350 ± .025

BASE COLOR: WHITE

METRIC		DIMENSIONS ARE IN MILLIMETERS		JKL COMPONENTS CORPORATION			
 THIRD ANGLE PROJECTION	TOLERANCE UNLESS OTHERWISE SPECIFIED		TITLE				
	1 PL +/- 0.3	2 PL +/- 0.30	T-1 NEO-WEDGE BASED LAMP WITH FILTER				
ANGLE +/- 0	DRAWN BY	APP'D BY	DATE	SIZE	FSCM NO.	DRAWING NO.	
	L. WENGSTROM	J.K.	3/31/05	A	55335	CNW5-8111/WHI/39-01-4C/S	
- CAD DRAWING - MANUAL REVISIONS NOT PERMITTED				SCALE	RELEASED DATE	REVISION DATE	REV. NO.
				NONE	3/7/05	3/31/05	A
							SHEET 1 OF 1