

REV.	DESCRIPTION/ECO NO.	DATE
REL	RELEASED AND CANCEL P-0109-12	11/19/01
A	0.15±0.05 TO 0.15 +0/-0.1	1/30/02

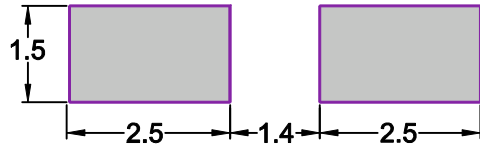

RECOMMENDED DIMENSIONS
FOR PC-BOARD PAD

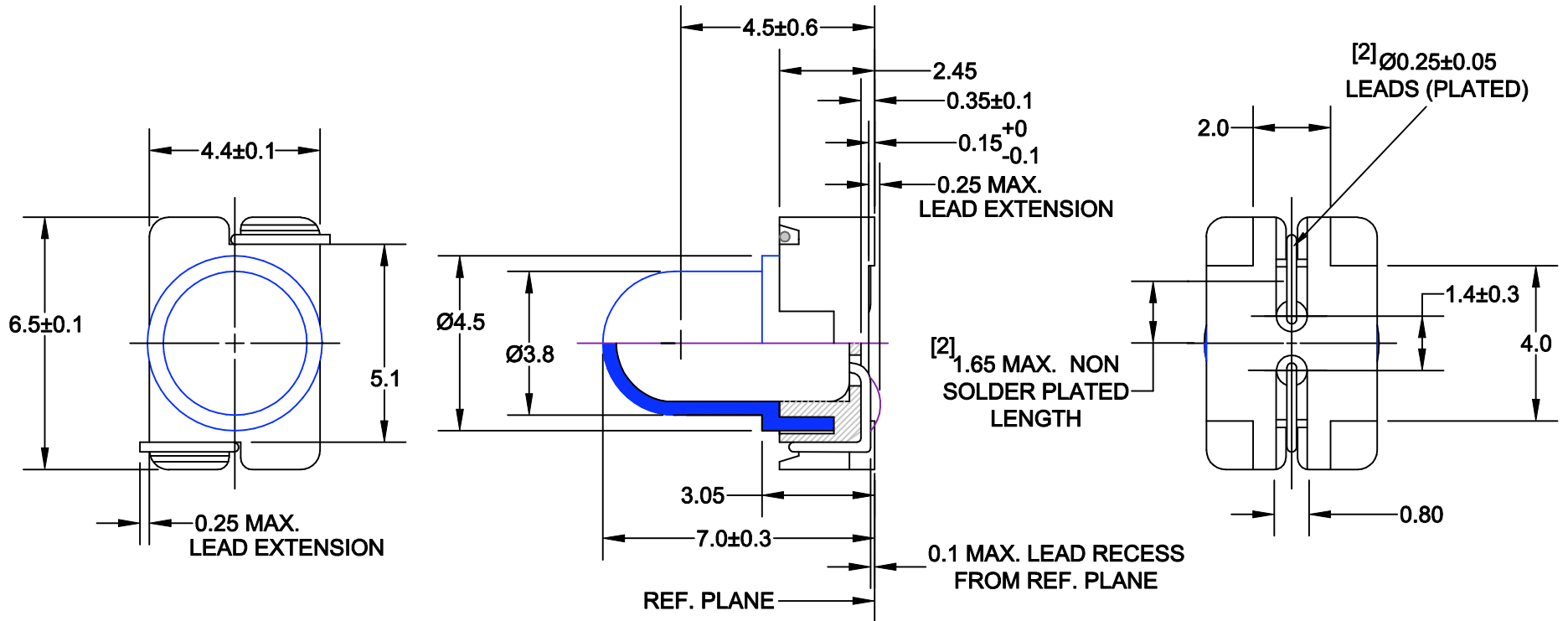
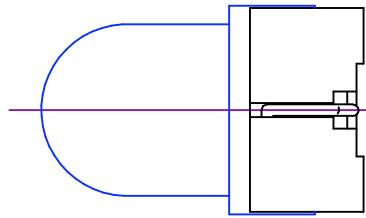

LAMP NUMBER: CW79					
VOLTS RATED	AMPS ± 10%	*MSCP ± 25%	*LUMENS ± 25%	AVERAGE LIFE HRS.	FILAMENT TYPE
6.0	.065	.110	1.38	**10,000	C-2R

*LAMP RATING ONLY WITHOUT BASE AND FILTER
**DERIVED FROM ACCELERATED TESTING

FILTER NUMBER: 39-35-5A	
COLOR COORDINATES (SPHERE)	
CHRYSLER BLUE/GREEN	u' = .1213 ± .016 @ 6.75V v' = .5028 ± .016 @ 6.75V

JKL PART NUMBER: CSD4-CW79/BLA/39-35-5A
BASE COLOR: BLACK

METRIC		DIMENSIONS ARE IN MILLIMETERS		JKL COMPONENTS CORPORATION			
THIRD ANGLE PROJECTION		TOLERANCE UNLESS OTHERWISE SPECIFIED		TITLE T-1 SURFACE MOUNT LAMP WITH BASE AND FILTER			
DRAWN BY L. WENGSTROM		APPVD BY J.K.		DATE 1/30/02	SIZE A	FSCM NO. 55335	DRAWING NO. CSD4-CW79/BLA/39-35-5A
- CAD DRAWING - MANUAL REVISIONS NOT PERMITTED				SCALE NONE	RELEASED DATE 11/19/01	REVISION DATE 1/30/02	SHEET 1 OF 1