

LOW PROFILE LED ALUMINUM CHANNEL RAIL WITH LENS

FEATURES:

- CUPLESS MOUNT DESIGN
- LOW PROFILE
- ACCOMODATES LED RIBBON UP TO 12mm WIDTH
- LENS OPTIONS IN CLEAR OR FROSTED
- SUPPLIED ALONE OR WITH LEDS, WIRE AND CONNECTOR INSTALLED (CONSULT JKL)
- SUPPLIED WITH ONE END CAP THAT HAS A HOLE FOR WIRE EXIT

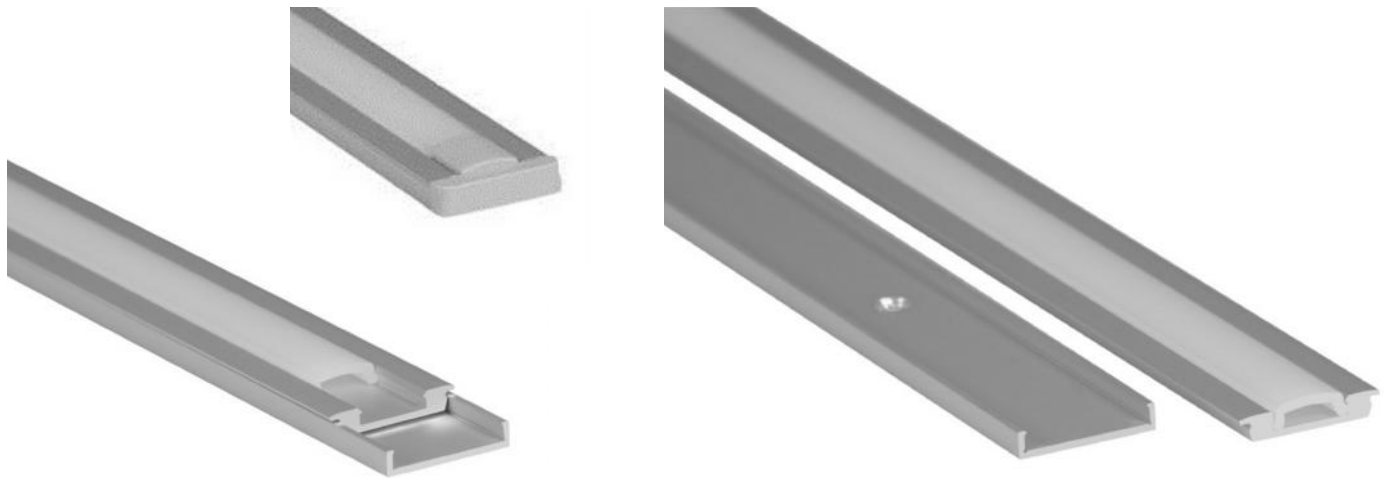

NOTES:

1. HOLE IN BOTTOM PLATE IS SHOWN TO CONVEY THE CONCEPT OF MOUNTING. PRODUCT DOES NOT COME WITH PRE-DRILLED HOLES UNLESS SPECIFIED.
2. EXTRUSION IS MADE OF 6063-T5 NATURAL ANODIZED ALUMINUM.
3. LENS IS MADE OF HIGH TEMPERATURE POLYCARBONATE.

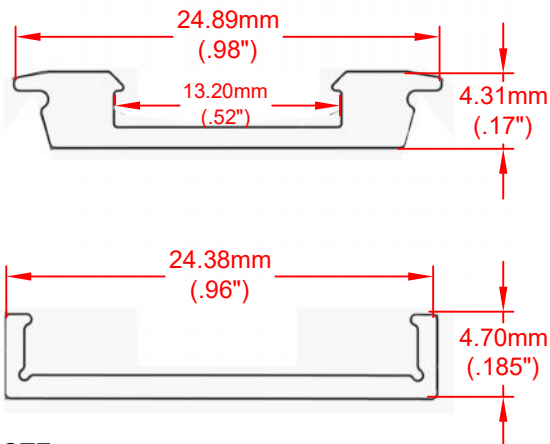

NOTE:
WITH LENS, THE HEIGHT IS 7.32mm (.288")

CHANNEL LENGTH AND LENS ORDERING GUIDE

| | | |
|------------------------------|--|--|
| ZFC-25LP SERIES | **** LENGTH | ** LENS |
| | Specify Length in mm up to 2400mm (94.48") | Specify Lens: F = Frosted C = Clear |
| Channel Rail Series ZFC-25LP | | |

JKL Part Number Example: ZFC-25LP1000-F Channel Series with 1 Meter (1000mm) Length and Frosted Lens.

Consult with JKL for availability of Lengths and Lens on hand for immediate needs.

| | | | | | | | | | | | |
|----------|------------------------|-------------|---|--|--|--|--|--|-------------------------------|--|--|
| | | | METRIC THIRD ANGLE PROJECTION | | DIMENSIONS ARE IN mm (INCHES) TOLERANCE UNLESS OTHERWISE SPECIFIED 1 PL +/- REF. 2 PL +/- REF. ANGLE +/- | | JKL COMPONENTS CORPORATION | | | | |
| | | | DRAWN BY L. WENGSTROM | | APPV'D BY DATE S.C. 6/17/19 | | TITLE LOW PROFILE LED ALUMINUM CHANNEL RAIL WITH LENS | | DRAWING NO. ZFC-25LP MULTI | | |
| RELEASED | | | 6/17/19 | | - CAD DRAWING - MANUAL REVISIONS NOT PERMITTED | | SCALE NONE | | RELEASED DATE 6/17/19 | | |
| REV. NO. | DESCRIPTION/ECO NUMBER | APPV'D DATE | | | | | REVISION DATE DATE | | REV. NO. SHEET 1 of 1 | | |